

- Trident Pro-2x
- Trident Pro-4x
- Trident Pro-6x

ATN Trident Pro



u s e r ' s g u i d e

Important Export Restrictions! Commodities, products, technologies and services contained in this manual are subject to one or more of the export control laws and regulations of the U.S. Government and they fall under the control jurisdiction of either the US Department of State or the US BIS-Department of Commerce. It is unlawful and strictly prohibited to export, or attempt to export or otherwise transfer or sell any hardware or technical data or furnish any service to any foreign person, whether abroad or in the United States, for which a license or written approval of the U.S. Government is required, without first obtaining the required license or written approval from the Department of the U.S. Government having jurisdiction. Diversion contrary to U.S. law is prohibited.



**AMERICAN
TECHNOLOGIES
NETWORK
CORP.**

TRIDENT PRO-2X

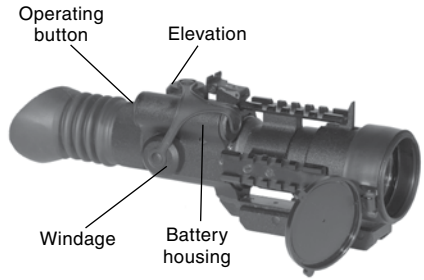
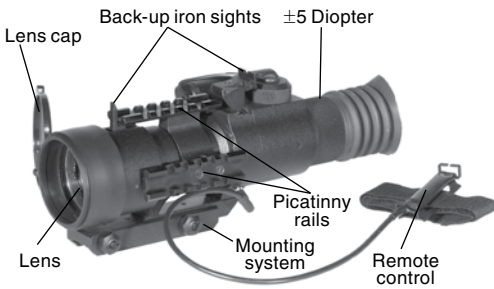

TRIDENT PRO-4X



TRIDENT PRO-6X

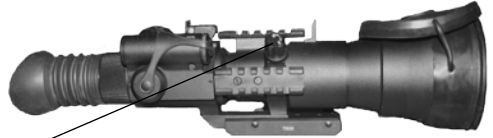

Manual lens focus control

DIGITAL INFRARED ILLUMINATOR

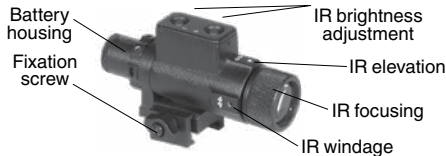

FEATURES

- Lightweight and compact design
- Top-notch performance with pro-oriented design
- Non-reflective matte black external surfaces (except optical elements)
- Back-up iron sights
- “Red on Green” reticle system with 1/2 moa adjustment
- Illuminated with red reticle center for optimal contrast to the dark or light target
- Automatic brightness control (ABC) and Automatic Highlight Protective system for IIT protection
- Easy to use one-button digital operational controls and adjustments.
- Detachable 450mW IR illuminator to operate in total darkness
- Can be mounted to a standard Weaver Rail
- Waterproof 20m for 1 hour

APPLICATION

The ATN Trident Pro is a rugged, 2,5X, 4X or 6X night vision weapon sight that provides excellent observation, target acquisition and aiming capabilities for advanced sports shooters or varmint hunters.

The Trident is available in a variety of Image Intensifier Tube (IIT) configurations to meet a wide range of technical and budget requirements.

The information in this manual furnished for information use only, is subject to change without notice, is not to be construed as a commitment by ATN Corp.

ATN Corp. assumes no responsibility or liability for any errors or inaccuracies that may appear in this book.

©2007 ATN Corp. All right reserved.

Even in conditions of unsteady brightness of the light, Automatic Brightness Adjustment System of the Trident Pro always keeps the IIT output brightness at constant level.

The Automatic Highlight Protective System of the Trident Pro preserves IIT screen from being burnt out and photocathode - from fast sensitivity loss in case when device is turned on occasionally in daytime light conditions without lens cap on.

NOTE: *The automatic highlight protective system and automatic brightness control system do not protect the device from damage by very bright light sources (a fire, headlights of the automobile, lanterns, etc.). Do not direct the device to the bright light sources.*

Perfect optics, high quality tubes and excellent performance make the ATN Trident Pro one of the best commercial night vision weapon sights available!

SPECIFICATIONS

	PRO-2X	PRO-4X	PRO-6X
Generation	2nd, 2nd+	2nd, 2nd+	2nd, 2nd+
Magnification	2.5x	4x	6x
Focal length.....	50 mm	108mm	160 mm
F Number.....	1:1.2	1:1.5	1:2
Focus.....	Fixed	Manual	Manual
Focusing range	20m to infinity	10m to infinity	25m to infinity
FOV	18 deg.	9.5 deg.	6.5 deg.
Reticle	Red On Green	Red On Green	Red On Green
Windage & elevation adjustments	1/2MOA	1/2MOA	1/2MOA
IR illuminator	450mw	450mw	450mw
Power Supply.....	3V CR123A	3V CR123A	3V CR123A
Battery life.....	30-50 h	30-50 h	30-50 h
Dimensions	275x95x85mm	330x90x95mm	390x95x95mm
Weight	1kg	1.2kg	1.6kg
Diopter adjustment	+/-5	+/-5	+/-5
Operating temperature	-40°C to +40°C	-40°C to +40°C	-40°C to +40°C

PREPARATION FOR OPERATION

Before getting started make sure to follow these steps:

- Install the 3V CR123A battery into its housing with the polarity order shown on the main body of the unit.
- Switch on the scope with the protective lens cover still attached to the lens.
- Make sure that the green luminance of the light intensifier tube is visible.
- Observe the scene, and adjust the diopter and/or lens for optimal image sharpness.
- You may now enter a dark environment or simply shut the lights off in order to darken the room.
- Next, remove the lens cap/daylight filter.
- Finally, you may wish to turn the infrared (IR) illuminator on. Notice the ability of the scope to see in total darkness with the aid of the IR illuminator.



OPERATING

MOUNTING

1. Slightly loosen the fixing screws on the 7/8" weaver mount built into the scope.
2. Place the scope on the weaver rail of the fire arm.
3. Tighten the fixing screws.

NOTE: Fixing screws may need to be re-tightened after continuous shooting.

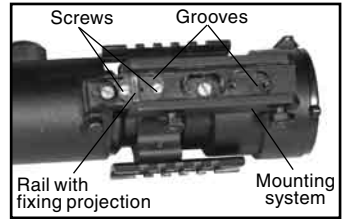

MOUNTING SYSTEM

The ATN Night Vision Riflescopes Mounting System allows to change the position of the riflescope flexibly on the weapon in relation to a shooter (in combination with the fixed positions already available on the weaver rail). For this purpose at the base of the mounting bracket there is a rail with a fixing projection. There are two grooves in the mounting bracket for mounting this rail. Besides it is possible to change the position of the riflescope additionally by 1/3 inch. To do this you will need to turn around the rail.

To change the position of the riflescope on the weaver rail additionally follow the steps mentioned below:

1. Unscrew the two screws attaching the rail to the mounting bracket.
2. Take the rail out of the groove.
3. Turn around the rail in case of necessity.
4. Place the rail into another groove.
5. Fix the rail with the two screws.

NOTE: If the rail does not come out easily, tighten one of the removed screws into the threaded aperture in the middle of the fixing projection of the rail. Rotate this screw push the rail out from a groove.

DIGITAL CONTROL

The ATN Trident Pro has a simple and easy to operate one-button digital control and adjustment.

To turn on: Press the operation button by one short push

To turn off: Press the operation button by one short push again

To adjust the reticle brightness:

- 1) When the scope is turned on press and hold operation button. Brightness will increase smoothly while the button is kept pressed. Release the button when necessary brightness is achieved.
- 2) Press and hold the button again to decrease the brightness. Adjustment could be easily seen if you look through the scope while adjustment is accomplished.

REMOTE CONTROL

All functions of digital control mentioned above are also available with the Remote Control operation button.

To connect Remote Control to the scope plug its cable connector into the socket at the device body. Then screw the fixing screw-nut.

Remote Control can be mounted on a weapon butt (or at any other convenient place) with its fastening belt.

FOCUSING

To focus your riflescope, first of all, you will need to adjust the diopter. Simply turn the diopter clockwise until it stops. Then, while looking through the diopter at a subject, slowly turn the diopter back counter clockwise until the grain in the image becomes sharp.

NOTE: We suggest that you focus the diopter during daylight with the cap on.

If you are using the Trident Pro-4X or Trident Pro-6X scope you should also focus the objective lens. To perform this operation rotate Manual lens focus control clockwise or counter clockwise until the image becomes most sharp is possible.

Please keep in mind that objective lens should be readjusted as you observe objects at different distances. The diopter should not be readjusted.

ADDITIONAL MOUNTING CAPABILITIES

There are three detachable Picatinny rails on the body of the scope for additional lighting, laser and other mission critical tools. Every rail fixes with two screws as shown on the figure.



IR ILLUMINATOR

Infrared (IR) Illuminators are common for night vision technology. The IR light greatly enhances the performance of your ATN Trident Pro scope, while remaining almost totally invisible to a naked eye. In dark environment, power on the ATN Trident Pro. Now, find a scene and examine it with the IR off and then with IR powered on. Note the difference in scene illumination. It is important to remember that the IR illuminator is simply an infra light source, and like any light source it may lose its effectiveness at a great distance.

To mount the IR illuminator onto the riflescope use the picatinny rail of the scope.

The IR illuminator control buttons are located on its side. To switch the Digital IR illuminator on/off press “+” and “-” buttons simultaneously. When the IR illuminator is switched on you can see the green LED lit. By pushing the buttons “+” and “-” you may adjust the IR brightness.

The IR beam is focusable to change the field of coverage. To change the beam width slightly turn the IR lens.

You could change the IR control panel fitting your needs. The wrench included into the set should be used for weakening the fixing nut located on the IR. Rotate the IR placing it to the most convenient position. Tighten the nut with the wrench to fix the new position.

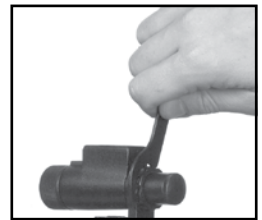
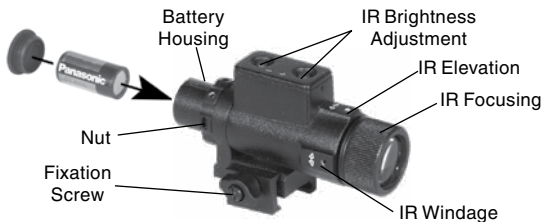

RETICLE

ATN Trident Pro reticle gives a clear aiming point, even when hard-to-see game blends at the background. Posts and crosshairs center section covers a minimum of the target allowing precision shots in a small target.

The size of illuminated red reticle corresponds to 1 yards at 100 yards distance.

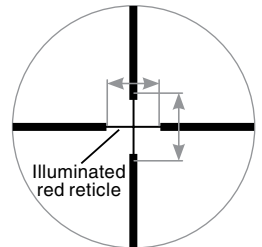

WINDAGE AND ELEVATION

The vertical and horizontal adjustments for the ATN Trident Pro can be achieved by turning the elevation and windage adjustment mechanisms (remove dust caps first). Each click equals 1/2 inch at 100 yards. When reaching the maximum range of rotation do not use force.

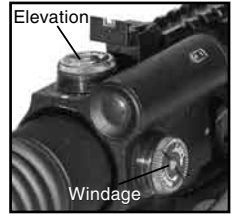

CLEANING THE EYEPIECE

You may need to clean the eyepiece of the riflescope from time to time in order to guarantee top performance. When you receive your riflescope you should check for dust on the eyepiece of the unit.

CAUTION: Use only Photographic lens cleaning tissue on these surfaces. Be careful not to scratch or smudge any of these surfaces. When using compressed air to blow dust away, make sure to avoid inverting the can while spraying. This can cause frozen propellant to exit the can, which can cause serious problems with the glass and phosphor screen

WARNINGS AND CAUTIONS

- Always remember to turn off the ATN Trident Pro scope when it is not in use. If you do not plan on using your scope for a period of more than 10 days, you should remove the batteries.
- Keep lens cap on when not in use.
- Avoid contact with dust, steam, and gas.
- The scope are not harmful to the user or the environment.
- Do not disassemble: **it will void your warranty.**
- Evaluate the scopes function by looking through it in a lit environment with the lens cap put on. Never use in daylight without the daylight filter lens cap on. Do not surpass ten minutes of testing.
- Never point the scope at a bright light source.
- Adverse atmospheric conditions such as fog, smog, or haze and a lack of ambient light (moon or starlight) may diminish the effective viewing distance. All technical data for this unit was compiled in a controlled environment.
- If you use the rubber eyecaps for a long period of time, you may suffer skin inflammation. If you develop any symptoms, consult a doctor immediately.

TROUBLESHOOTING

Q: Flashes, flickers, or clicking occur while operating

S: If it occurs within the first five minutes of inserting new batteries, it is normal and the device will resume normal operation soon thereafter. If it occurs for more than 10 minutes, contact your dealer or other authorized service representative for service instructions.

Q: Dark spots on screen.

S: This may be dust on the lens, please clean according to instructions. They may also be Cosmetic blemishes in the intensifier tube which are a by-product of the manufacturing process. This is normal and will not affect the life or performance of the unit.

Q: Image not clear.

S: Adjust eyepiece diopter correction and/or objective lens. If problem persists, increase viewing distance

Q: Fixed-pattern noise in a honeycomb shape.

S: Usually a cosmetic blemish characterized by a faint honeycomb-type pattern. This usually occurs when viewing very bright lights.

Q: A pattern of dark thin lines which look like chicken wire.

S: Turn on illuminator, if purchased. If illuminator doesn't brighten image, replace batteries. If problem persists, contact ATN for service instructions.

2 YEAR PRODUCT WARRANTY

This product is guaranteed to be free from manufacturing defects in material and workmanship under normal use for a period of 2 (two) years from the date of purchase. In the event a defect that is covered by the foregoing warranty occurs during the applicable period stated above, ATN, at its option, will either repair or replace the product, and such action on the part of ATN shall be the full extent of ATN's liability, and the Customer's sole and exclusive remedy. This warranty does not cover a product (a) used in other than its normal and customary manner; (b) subjected to misuse; (c) subjected to alterations, modifications or repairs by the Customer or by any party other than ATN without prior written consent of ATN; (d) special order or "close-out" merchandise or merchandise sold "as-is" by either ATN or the ATN dealer; or (e) merchandise that has been discontinued by the manufacturer and either parts or replacement units are not available due to reasons beyond the control of ATN. ATN shall not be responsible for any defects or damage that in ATN's opinion is a result from the mishandling, abuse, misuse, improper storage or improper operation, including use in conjunction with equipment which is electrically or mechanically incompatible with or of inferior quality to the product, as well as failure to maintain the environmental conditions specified by the manufacturer. **CUSTOMER IS HEREBY NOTIFIED THAT OPERATION OF THE EQUIPMENT DURING DAYLIGHT HOURS OR UNDER ANY EXCESSIVE LIGHT CONDITIONS MAY PERMANENTLY DAMAGE THE INTERNAL COMPONENTS OF THE UNIT AND SAID DAMAGE WILL NOT BE COVERED UNDER THIS WARRANTY.** This warranty is extended only to the original purchaser. Any breach of this warranty shall be waived unless the customer notifies ATN at the address noted below within the applicable warranty period.

The customer understands and agrees that except for the foregoing warranty, no other warranties written or oral, statutory, expressed or implied, including any implied warranty of merchantability or fitness for a particular purpose, shall apply to the product. All such implied warranties are hereby and expressly disclaimed.

LIMITATION OF LIABILITY

ATN will not be liable for any claims, actions, suits, proceedings, costs, expenses, damages or liabilities arising out of the use of this product. Operation and use of the product are the sole responsibility of the Customer. ATN's sole undertaking is limited to providing the products and services outlined herein in accordance with the terms and conditions of this Agreement. The provision of products sold and services performed by ATN to the Customer shall not be interpreted, construed, or regarded, either expressly or implied, as being for the benefit of or creating any obligation toward any third party of legal entity outside ATN and the Customer; ATN's obligations under this Agreement extend solely to the Customer. **ATN's liability hereunder for damages, regardless of the form or action, shall not exceed the fees or other charges paid to ATN by the customer or customer's dealer. ATN shall not, in any event, be liable for special, indirect, incidental, or consequential damages, including, but not limited to, lost income, lost revenue, or lost profit, whether such damages were foreseeable or not at the time of purchase, and whether or not such damages arise out of a breach of warranty, a breach of agreement, negligence, strict liability or any other theory of liability.**

PRODUCT WARRANTY REGISTRATION

In order to validate the warranty on your product, ATN must receive a completed Product Warranty Registration Card for each unit. Please complete the form below and immediately mail it to our Service Center: ATN Corp., 1341 San Mateo Avenue, South San Francisco, CA 94080. Products qualifying for warranty repair will be either repaired or replaced within 10 business days of receipt of merchandise unless the customer is notified otherwise.

OBTAINING WARRANTY SERVICE

To obtain warranty service on your unit, take or send the product, postage paid, with a copy of your sales receipt to our service center, ATN Corporation at the address noted above. All merchandise must be fully insured with the correct postage; ATN will not be responsible for improper postage, or, missing or damaged merchandise during shipment.



For customer service and technical support, please contact
American Technologies Network Corp.

North American Office

1341 San Mateo Avenue, South San Francisco, CA 94080
phone: 800-910-2862, 650-875-0130; fax: 650-875-0129

European Office

phone: 44(0)870-0111286, fax: 44(0) 845-3349142

The following countries can use our
toll free number 00 800 9102-8620

Austria, France, Germany, Holland, Italy, Spain, Sweden, Switzerland

www.atncorp.com